

Superreel® - Industrial Reel

ASSH510D SERIES



FEATURES

- Dual pedestal, Economy, Low pressure.
- Full flow shaft and swivel.
- Reel drive springs manufactured from high-quality, scaleless blue tempered steel.
- Anti-lockout design: Ratchet prevents lockup when hose is fully extended, eliminating the need to manually release the pawl at the reel.
- Superior performance: Swivel and reel ball bearings reduce torque load on power spring for smooth retraction and durability.
- Corrosion resistant: Sealed bearings prevent contamination and minimize maintenance.
- Easy installation and maintenance: Factory lubricated one-piece power spring cassette make installation safer and maintenance easier.

1



WWW.SUPERREEL.COM

Email: sales@superreel.com

Superreel® - Industrial Reel

- Adjustable and Versatile: Guide arm adjust to wall, floor, vehicle, overhead positions.

Narrow design allows for maximum use of available space.

DIMENSIONS

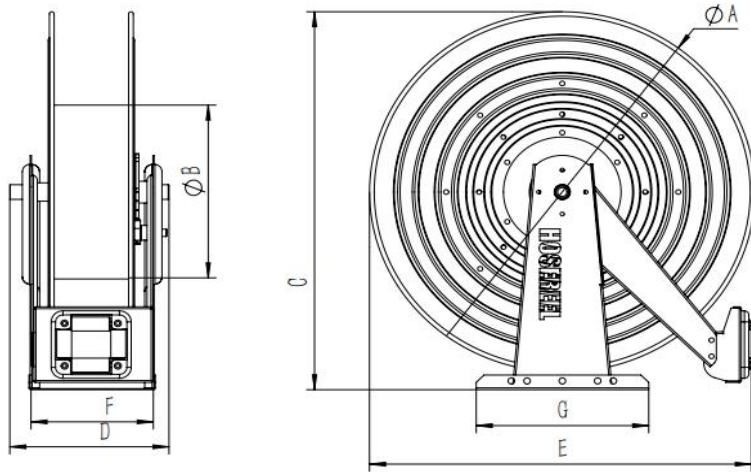

| P/N | Port&core number | HOSE-ID. or CABLE-square | Pressure or lmax | Working length | Reel inlet | Hose outlet | A | B | C | D | E | F | G | H | I | J | K |
|--------------------|------------------|--------------------------|------------------|----------------|------------|-------------|-------------------------------|-----|-----|-----|-----|-----|-----|-----|-----|---|----|
| ASSH510D0104016015 | 1 | 1/2" | 1.6Mpa | 15m | M18*1.5.M | BSPT1/4".M | 485 | 237 | 515 | 203 | 486 | 161 | 220 | 120 | 180 | 4 | 11 |
| | | | | | | | Dimensions are in millimeters | | | | | | | | | | |

