

Superreel® - Industrial Reel

EESC660D SERIES

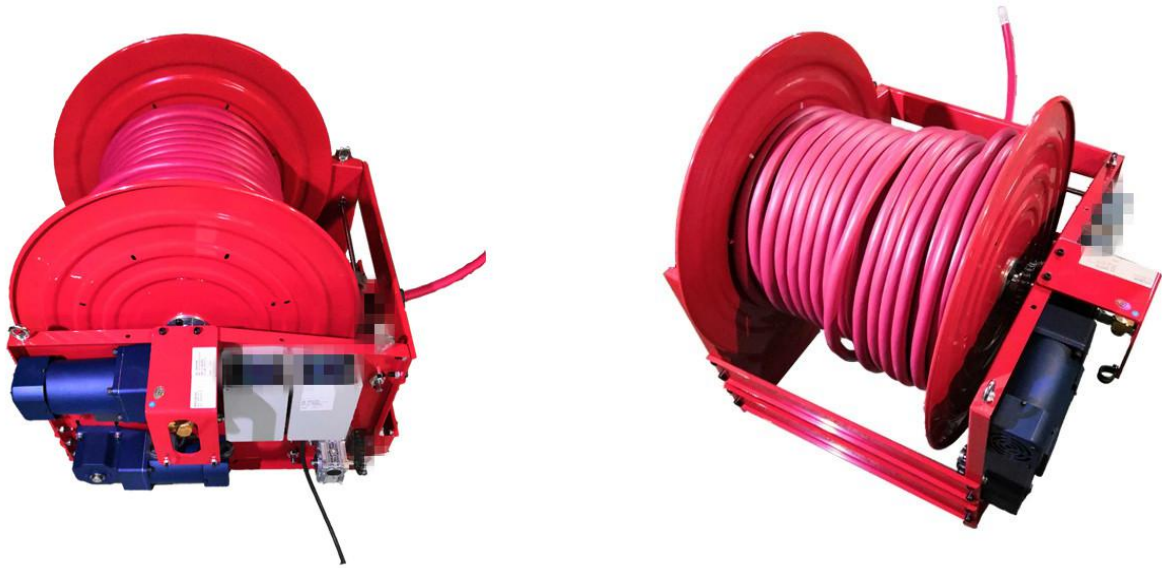

FEATURES

- To handle live electric cable/cord.
- Automation, Powered by electric motor. Large-diameter, Large capacity, Auto-distribution.
- Silver alloy slip ring.
- Durable abrasion and corrosion resistant baked-on power coat finish.
- Rugged construction: Steel drum and all bolted construction. Vibration-proof self-locking fasteners.
- Low maintenance: Dual main bearings never need lubrication.
- Compact for critical space requirements.
- Shipped completely assembled, ready to install.

1



WWW.SUPERREEL.COM

Email: sales@superreel.com

Superreel® - Industrial Reel

DIMENSIONS

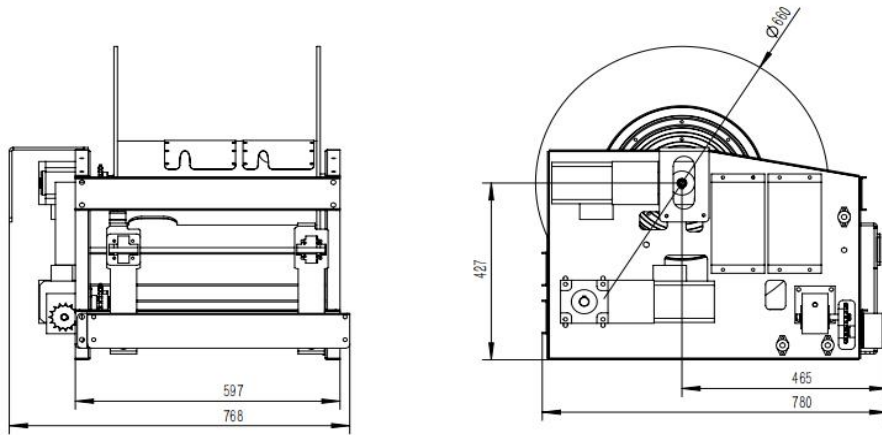

P/N	Port&core number	HOSE-ID. or CABLE-square	Pressure or lmax	Working length	Reel inlet	Cable outlet	A	B	C	D	E	F	G	H	I	J	K
EESC660D0405010100	24	1.5 ²	10A	100m	Bare wire	Bare wire	660	200	757	768	780	597	699	568	500	4	13
EESC660D0406020100	10	2.5 ²	20A	100m	Bare wire	Bare wire	660	200	757	768	780	597	699	568	500	4	13
EESC660D0409050100	4	6 ²	50A	100m	Bare wire	Bare wire	660	200	757	768	780	597	699	568	500	4	13
EESC660D0405065100	4	10 ²	65A	100m	Bare wire	Bare wire	660	200	757	768	780	597	699	568	500	4	13

220VAC, Working length more than 50 meters length only supports mobile installation

Dimensions are in millimeters

