

Superreel® - Industrial Reel

ESDH1200F SERIES



FEATURES

- Heavy duty. All-steel construction.
- For thermoplastic welded double hose with bigger diameter and bigger floating rate
- Available in Left or Right version
- Fixation by mounting flangel
- Self winding by permanent spring force
- Full flow shaft swivels.
- Superior performance: Swivel and reel ball bearings reduce torque load on power spring for smooth retraction and durability.
- Corrosion resistant: Sealed bearings prevent contamination and minimize maintenance.
- Easy installation and maintenance: Factory lubricated one-piece power spring cassette make installation safer and maintenance easier.



Superreel® - Industrial Reel

- Adjustable and Versatile: Guide arm adjust to wall, floor, vehicle, overhead positions.

Narrow design allows for maximum use of available space.

DIMENSIONS

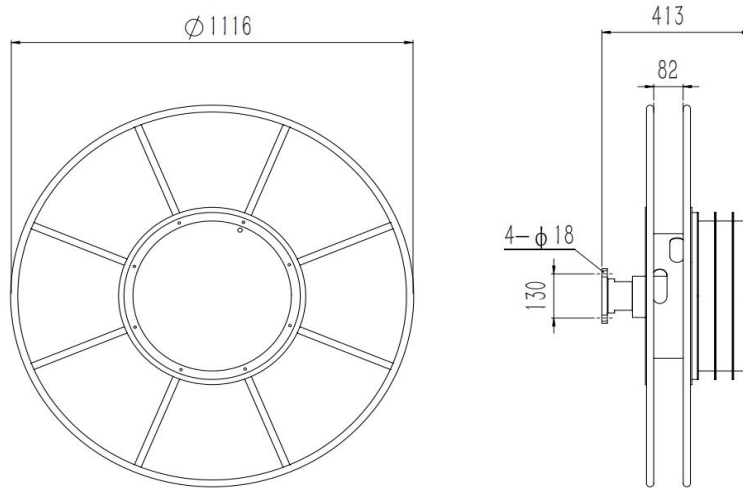

P/N	Port&core number	HOSE-ID. or CABLE-square	Pressure or lmax	Working length	Reel inlet	Hose outlet	A	B	C	D	E	F	G	H	I	J	K
ESDH1200F0204220012	2	1/2"	22MPA	18m	M27*1.5.M	M27*1.5.F	1116	366	1116	413	1116	160	160	130	130	4	18
ESDH1200F0205220016	2	3/4"	22MPA	16m	M27*1.5.M	M27*1.5.F	1116	366	1116	413	1116	160	160	130	130	4	18
ESDH1200F static pressure: 35MPA, dynamic pressure: 22MPA							Dimensions are in millimeters										

