

Superreel® - Industrial Reel

ASSC220S SERIES

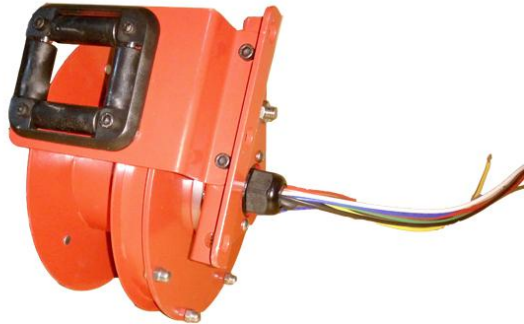

FEATURES

- To handle live electric cable/cord.
- Professional grade heavy duty steel construction.
- Silver alloy slip ring.
- Reel drive springs manufactured from high-quality, scaleless blue tempered steel.
- Durable abrasion and corrosion resistant baked-on power coat finish.
- Adjustable bumper stop allow any desired length of cord or cable to be maintained outside the reel.
- Automatic spring retraction for quick cord rewind.
- Compact, Ultralight for critical space requirements.



Superreel® - Industrial Reel

DIMENSIONS

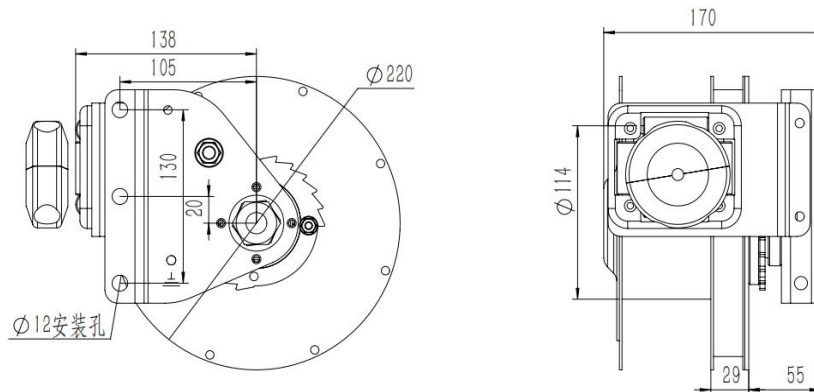

P/N	Port&core number	HOSE-ID. or CABLE-square	Pressure or I _{max}	Working length	Reel inlet	Cable outlet	A	B	C	D	E	F	G	H	I	J	K
ASSC220S0305010005	3	1.5 ²	10A	5m	Bare wire	Bare wire	220	114	220	170	248	170	30	65	0	3	12
ASSC220S0306020005	3	2.5 ²	20A	5m	Bare wire	Bare wire	220	114	220	170	248	170	30	65	0	3	12
Suitable for super flexible cable							Dimensions are in millimeters										

